



INK CONCENTRATED STAINS FOR WOOD

TINTOMETRIC SYSTEM



“INK” IRIDEA COLOR TINTOMETRIC SYSTEM

The IRIDEA COLOR tintometric system uses an innovative series of stains called INK and takes into account the current color trends in order to achieve a trendy visual result and a great chromatic impact. ICA Group invests heavily in the development of new colors to meet more and more the needs of professionals, designers and architects, who must be able to provide innovative, high-performance solutions.

INK concentrated stains are solvent-based and general-purpose. Starting from 10 primary colors, they allow you to get 150 ready-to-use stains and many other intermediate shades, including pastel shades (mixed with white). They can all be diluted with both solvent and water, with the exception of the stains mixed with white (which contain white primary color INKBP), which can only be diluted with solvent.

SYSTEM BENEFITS

1. Simple formulation.
2. Consistent replicability.
3. Save money:
 - lower purchase costs compared to pre-diluted (ready-for-use) stains;
 - avoid stain wastage;
 - eliminate unsold stock;
 - reduce packaging and disposal costs.
4. Reduce timescales and become autonomous: no need to wait for the stain to be delivered, because it can be produced at your choice at any time.
5. Acquire an in-depth understanding of the formulation of stains.





COLOR CHART

The “INK” IRIDEA COLOR chart is divided into **10 primary colors (INK..P)**, which can be used to obtain the **15 secondary colors** shown in the chart (**INK..S**) as well as any other sample color tone.

The chart also includes **pastel shades (mixed with white)**, that makes it unique in its kind. Each INK stain (primary and secondary) is available in 6 different blends, 2 of which with the addition of white (INKB), for a total of 150 shades.

PRIMARY COLORS

The shades shown in the chart follow the RAL number system: e.g. 1 = yellow, 2 = orange, 3 = red, 4 = reddish purple, 5 = blue, 6 = green, 7 = gray, 8 = brown , 9 = black.

 **INK10P**
Lemon Yellow

 **INK11P**
Chrome Yellow

 **INK20P**
Orange

 **INK30P**
Red

 **INK40P**
Reddish purple

 **INK50P**
Blue

 **INK60P**
Green

 **INK80P**
Brown

 **INK90P**
Black

 **INKBP**
White



SECONDARY COLORS



DISCOVER THE COLORS OF THE CHART

PRIMARY COLORS (INK..P)

Ex. INK10P40 | 40% INK10P + 60% solvent/water



SECONDARY COLORS (INK..S)

Ex. INK12S15 | 15% INK12S + 85% solvent/water



INK12S | 5% INK80P + 95% INK11P



*COLORS WITH WHITE

Ex. INK81SB1005 | 10% INKBP + 0.5% INK81S + 89.5% solvent

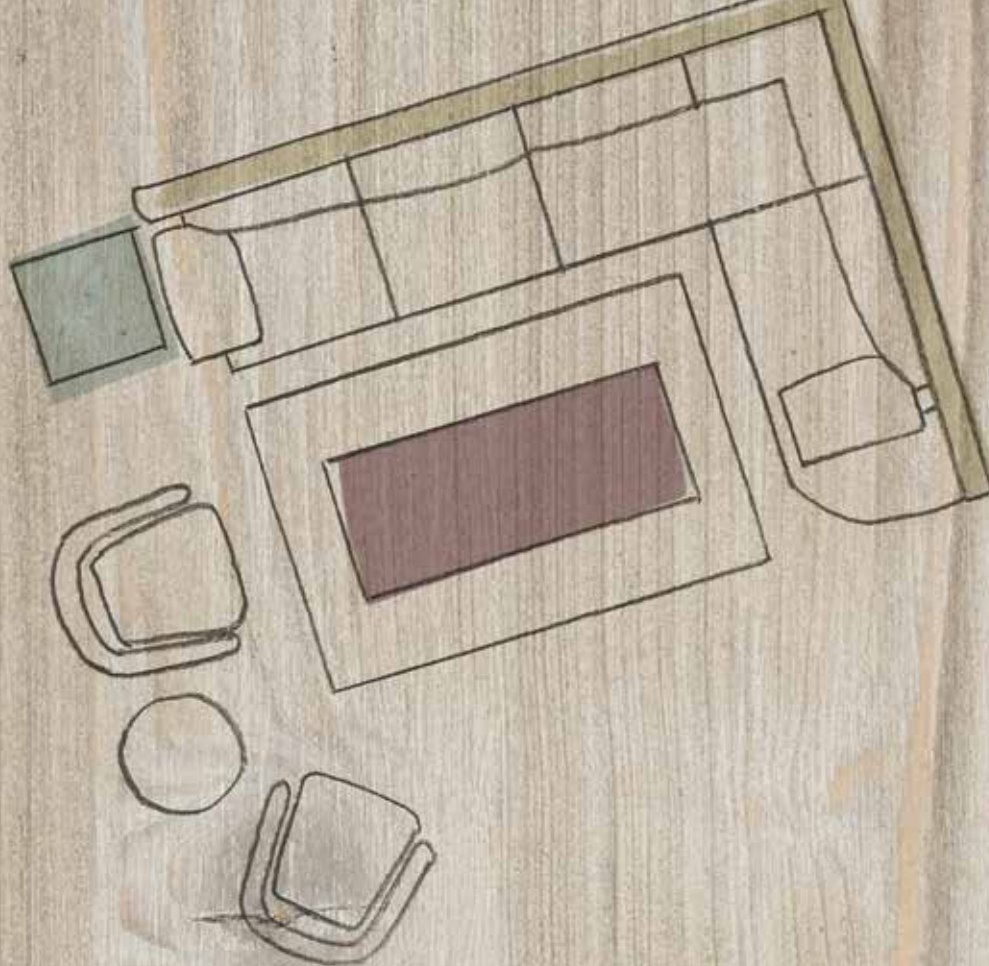

ICA SpA
Via Sandro Pertini 52
62012 Civitanova Marche (MC) Italy
Tel. +39 0733 8080 - Fax +39 0733 808140
info@icaspa.com

Divisione ITALIAN COATINGS
Via Alcide De Gasperi 73
36060 Romano D'Ezzelino (VI) Italy
Tel. +39 0424 8386 - Fax +39 0424 37497
info@italiancoatings.com

www.icaspa.com

